



# PASSENGER SAFETY INSTRUCTIONS

We are committed to your safety & security. Scan for videos & resources.

Español, Français, 中国人

## EMERGENCY EXIT ROUTES

Follow instructions from Amtrak crew or first responders. Never exit a moving train.

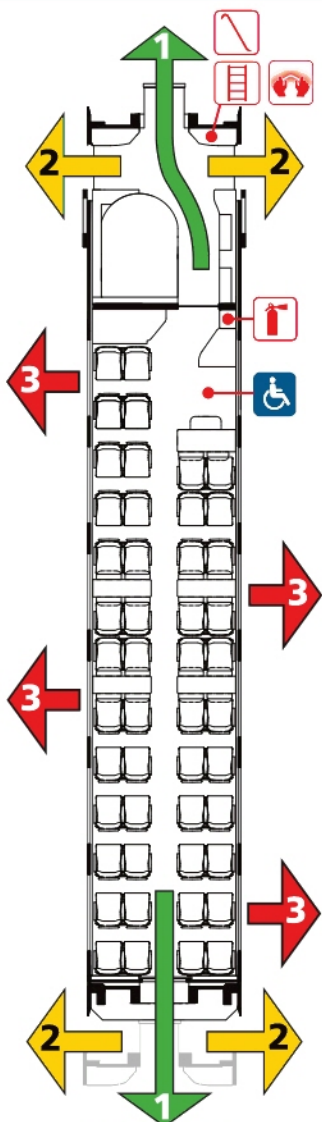

NO EXIT ON  
CARS 1 & 9

### 1 Move to next train car.

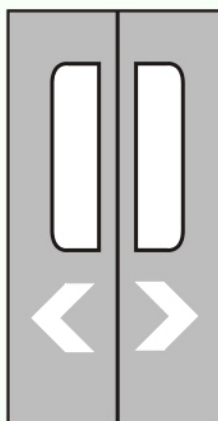

Doors may be pried apart manually if power fails.

Stay onboard the train. Inside the train may be the safest location.

### 2 Exit through side doors.



1

Lift the emergency door cover up.

2



Pull red handle down to release door.

3

If needed, use emergency ladder located at the end of the train car.



### 3 Exit through emergency windows.

1



Pull and remove the cover.

2



Strike red circle repeatedly at top of window until glass fractures.

3



Place hands on film to push glass out.

4



If needed, use emergency ladder located at the end of the train car.

When exiting the train, look for other trains, electrical wires and steep drops.



Please do not remove card from train



Español, Français, 中国人

# PASSENGER SAFETY INSTRUCTIONS

We are committed to your safety & security. Scan for videos & resources.



## GET-A-GRIP WHEN MOVING ABOUT

For your safety and stability, hold on to handrails, luggage racks, seat backs and tables.



## WATCH TRIPPING HAZARDS

Avoid tripping hazards by keeping all luggage and personal items out of aisles and vestibules. In an emergency leave luggage behind.



## WEAR SHOES WHEN WALKING ONBOARD

For your safety, refrain from walking barefoot or in socks in the train. Be cautious if you're wearing non-rubber sole shoes; they may cause slipping.



## WAIT IN CAR FOR TRAIN TO STOP

Do not stand in the vestibules until the train comes to a complete stop.



## SEE SOMETHING? SAY SOMETHING!

If you see suspicious behavior or activity, contact Amtrak Police at 800-331-0008, text 27311 (APD11) or call 911.



## IF YOU, OR A PASSENGER, NEED HELP

Attendant call buttons are located throughout the train.



## NO SMOKING

Smoking or vaping is prohibited anywhere onboard the trains, including the restrooms.



## ONBOARD EMERGENCY EQUIPMENT

Fire extinguisher, emergency tools, ladder and light sticks are located near the restrooms.

Look for yellow and red emergency signs throughout the train cars.



Customer service questions, please call 800-USA-RAIL (800-872-7245)